

CAST IRON PUMPS

POMPE IN GHISA

MADE IN ITALY

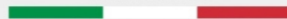

REV MARZO 15

COME ORDINARE / HOW TO ORDER

PG2I 15 D L

Bocche / Ports

P = posteriori/rear ports

S = laterali/side ports

Rotazione / Rotation

D = destra/cw

S = sinistra/ccw

R = reversibile/bidirectional

Cilindrata / Capacity

Tipo pompa / pump type

POMPE AD INGRANAGGI

GEAR PUMPS

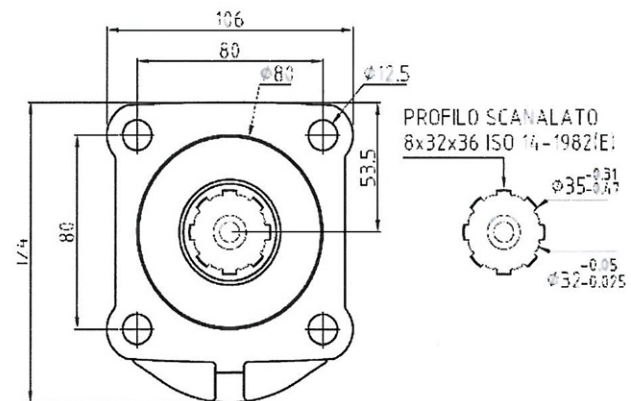
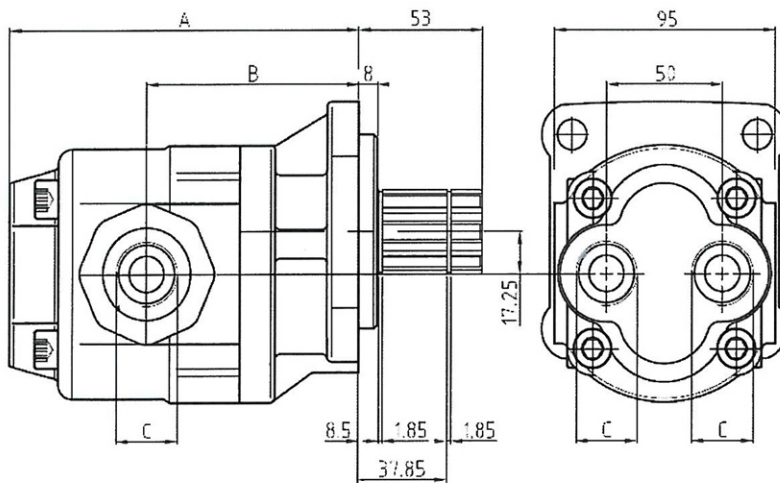
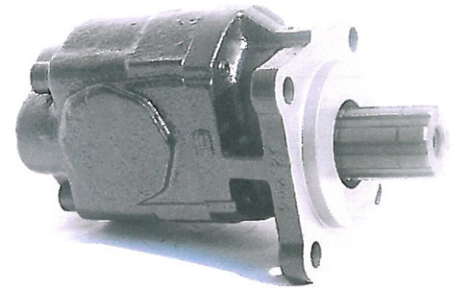

TIPO Type	Cilind. Cm ³ /giro Capacity Cm ³ /rev.	B	A	C		Peso Kg. Weight Kg.
				Aspirazione Inlet	Mandata Outlet	
PG2 - 11	11,3	114	81	1/2"G	1/2"G	5.2
PG2 - 15	15,5	120	87	3/4"G	3/4"G	5.4
PG2 - 25	26,1	135	90	3/4"G	3/4"G	6.1
PG2 - 40	38,1	153	92	3/4"G	3/4"G	6.8

CARATTERISTICHE PRINCIPALI / MAIN FEATURES

TIPO - Type		11	15	25	40
Cilindrata Capacity	cc/giro cc/rev	11.3	15.5	26.1	38.8
P1 Pressione max continua Max working pressure	bar	300	260	200	140
P2 Pressione di punta Peak pressure	bar	400	320	240	175
Velocità max continua per pressione P1 Max speed for P1 pressure	giri/min r.p.m.	2800	2500	2300	2000
Velocità max a vuoto Max speed without load	giri/min r.p.m.	3500	3500	2700	4000
Velocità min per P1 (unidir.) Min speed for P1 (unidirect.)	giri/min r.p.m.	750	350	300	250

Per motori reversibili ridurre la pressione del 15%
For bi-directional pump pressure is reduced by 15%

DIAGRAMMI / DIAGRAMS

CILINDRATA / CAPACITY

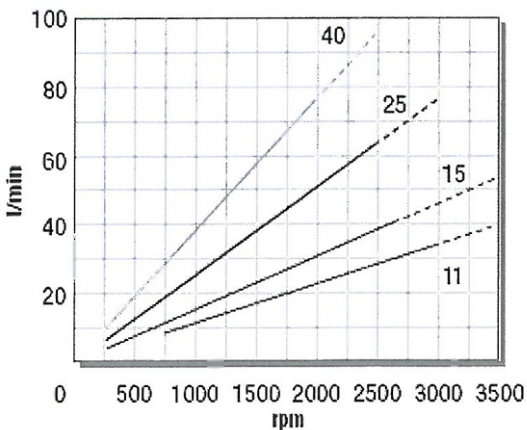

POT. ASSORBITA / INPUT POWER

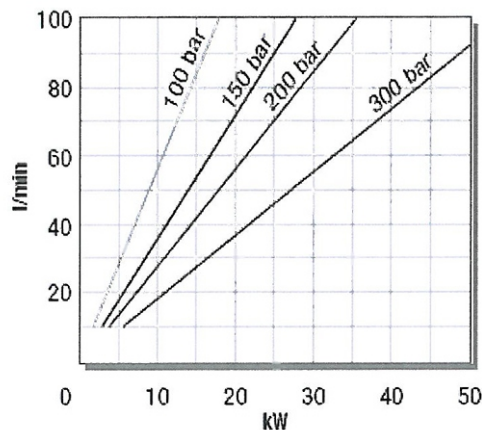

COPPIA. ASSORBITA / INPUT TORQUE

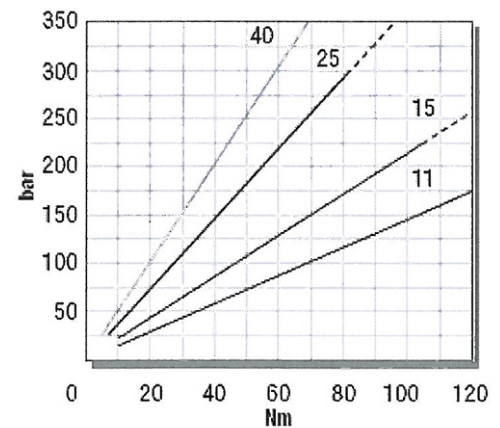

CONDIZIONI DI LAVORO / WORKING CONDITIONS

Temperatura d'esercizio Working temperature	-10° +80°C
Campo di viscosità Operating viscosity	12 / 110 cSt
Contaminazione (NAS 1638) Contamination class (NAS 1638)	11 / 12

COME ORDINARE / HOW TO ORDER

PG2U 15 D L

Bocche / Ports

P = posteriori/rear ports

S = laterali/side ports

Rotazione / Rotation

D = destra/cw

S = sinistra/ccw

R = reversibile/bidirectional

Cilindrata / Capacity

Tipo pompa / pump type

POMPE AD INGRANAGGI GEAR PUMPS

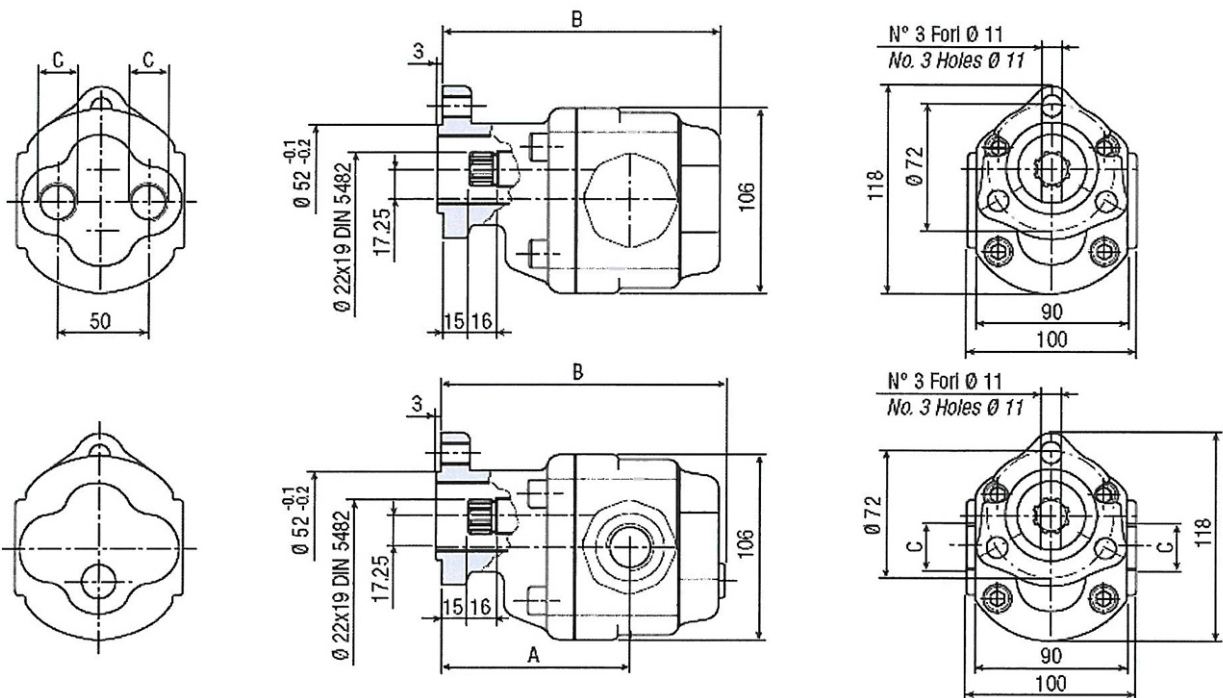
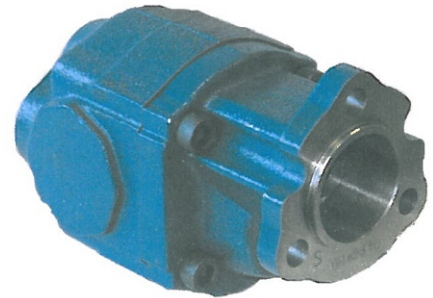

TIPO Type	Cilind. Cm ³ /giro Capacity Cm ³ /rev.	B	A	C		Peso Kg. Weight Kg.
				Aspirazione Inlet	Mandata Outlet	
PG2 - 11	11,3	114	81	1/2" G	1/2" G	5.2
PG2 - 15	15,5	120	87	3/4" G	3/4" G	5.4
PG2 - 25	26,1	135	90	3/4" G	3/4" G	6.1
PG2 - 40	38,1	153	92	3/4" G	3/4" G	6.8

CARATTERISTICHE PRINCIPALI / MAIN FEATURES

TIPO - Type		11	15	25	40
Cilindrata Capacity	cc/giro cc/rev	11.3	15.5	26.1	38.8
P1 Pressione max continua Max working pressure	bar	300	260	200	140
P2 Pressione di punta Peak pressure	bar	400	320	240	175
Velocità max continua per pressione P1 Max speed for P1 pressure	giri/min r.p.m.	2800	2500	2300	2000
Velocità max a vuoto Max speed without load	giri/min r.p.m.	3500	3500	2700	4000
Velocità min per P1 (unidir.) Min speed for P1 (unidirect.)	giri/min r.p.m.	750	350	300	250

Per motori reversibili ridurre la pressione del 15%
For bi-directional pump pressure is reduced by 15%

DIAGRAMMI / DIAGRAMS

CILINDRATA / CAPACITY

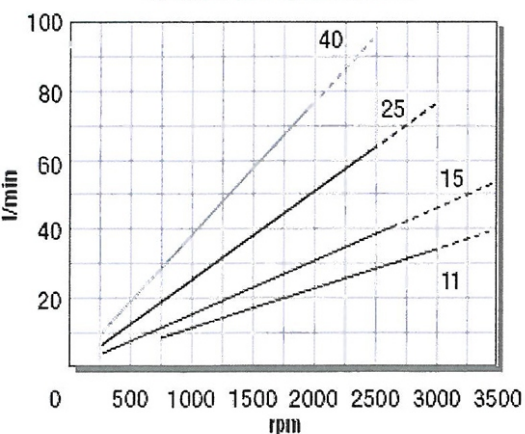

POT. ASSORBITA / INPUT POWER

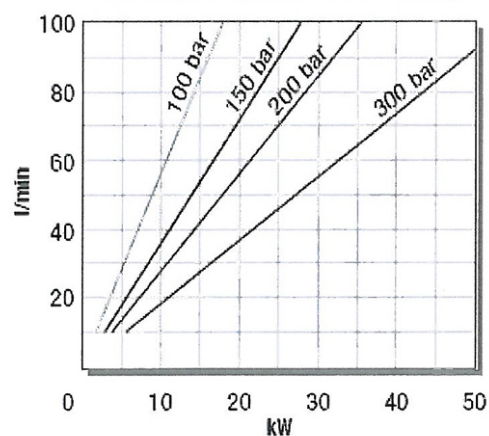

COPPIA. ASSORBITA / INPUT TORQUE

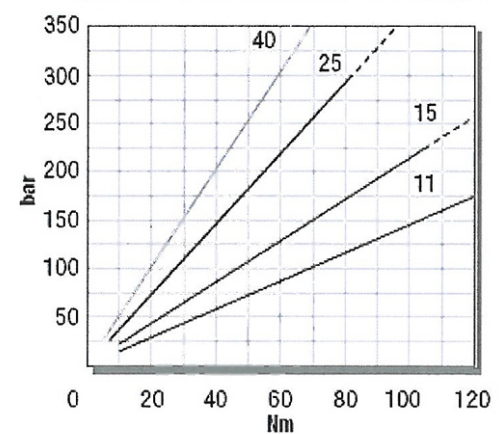

CONDIZIONI DI LAVORO / WORKING CONDITIONS

Temperatura d'esercizio Working temperature	-10° +80°C
Campo di viscosità Operating viscosity	12 / 110 cSt
Contaminazione (NAS 1638) Contamination class (NAS 1638)	11 / 12

COME ORDINARE / HOW TO ORDER

PF3U 64 D

Rotazione / Rotation

D = destra/cw

S = sinistra/ccw

R = reversibile/bidirectional

Cilindrata / Capacity

Tipo pompa / pump type

POMPE AD INGRANAGGI GEAR PUMPS

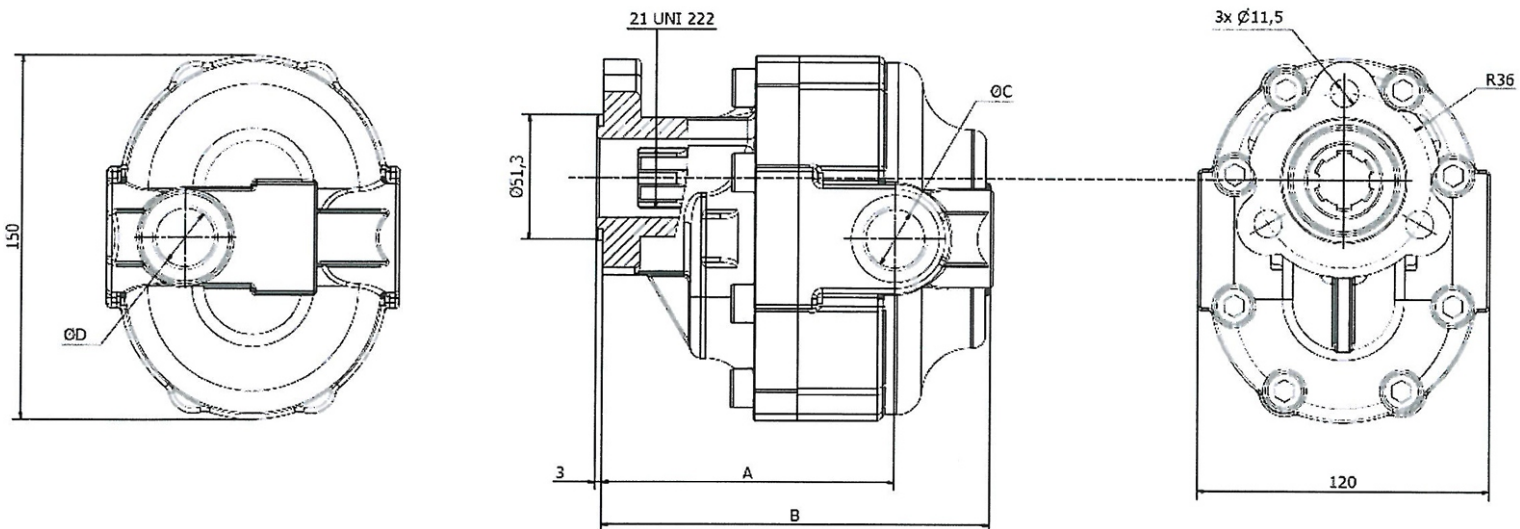
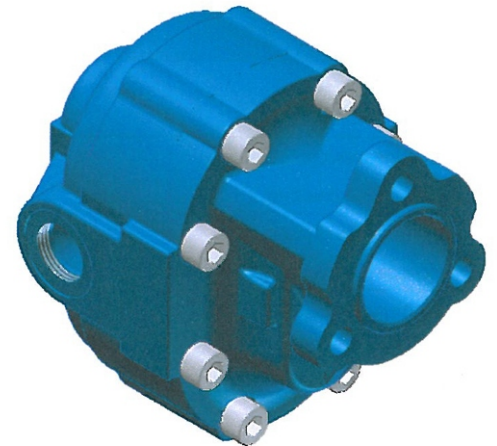

TIPO Type	Cilind. Cm ³ /giro Capacity Cm ³ /rev.	A	B	C		Peso Kg. Weight Kg.
				Aspirazione Inlet	Mandata Outlet	
PF3 - 25	24.9	135	175	3/4"	1/2"	11.6
PF3 - 35	34.3	141	187	3/4"	1/2"	12.6
PF3 - 45	45.2	131	194	1"	3/4"	13.1
PF3 - 55	54.5	137	200	1"	3/4"	13.7
PF3 - 64	63.9	143	206	1"	3/4"	14.5
PF3 - 80	78.7	143	216	1"-1/4"	1"	14.8

CARATTERISTICHE PRINCIPALI / MAIN FEATURES

Tipo - Type		25	35	45	55	64	80
Cilindrata Capacity	Cm ³ / giro Cm ³ / rev	24.9	34.3	45.2	54.5	63.9	78.7
P1 Pressione max continua Max working pressure	Bar	300	300	260	240	220	200
P3 Pressione max di picco Max peak pressure	Bar	450	450	400	380	330	300
Velocità max per pressione P1 Max speed for P1 pressure	Giri / min Rpm	2200	2200	2200	2000	1800	1500
Velocità max a vuoto Max speed without load	Giri / min Rpm	2800	2800	2800	2500	2500	2200

Per pompe reversibili ridurre la pressione del 15%
For bi-directional pump pressure is reduced by 15%

DIAGRAMMI / DIAGRAMS

CILINDRATA / CAPACITY

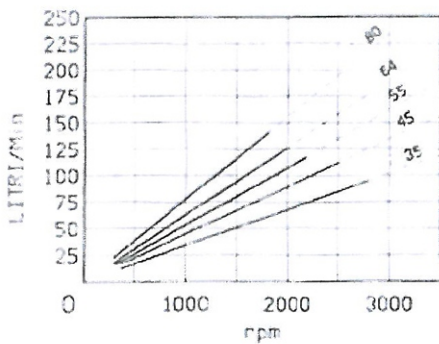

POT. ASSORBITA / INPUT POWER

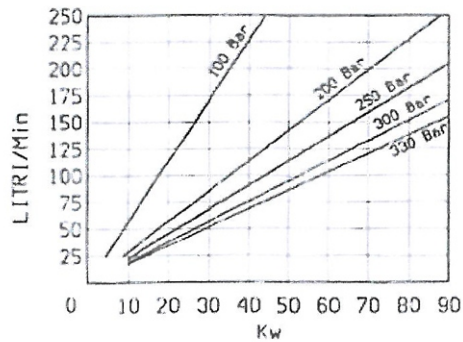

COPPIA. ASSORBITA / INPUT TORQUE

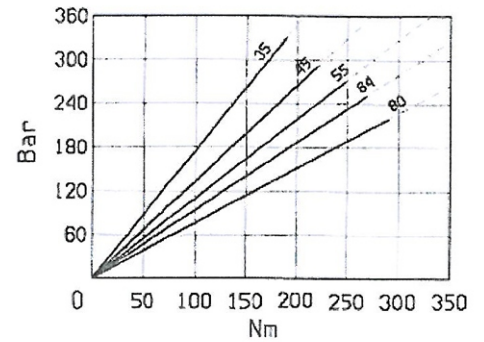

CONDIZIONI DI LAVORO / WORKING CONDITIONS

Temperatura d'esercizio Working temperature	-10° +80°C
Campo di viscosità Operating viscosity	12 / 110 cSt
Contaminazione (NAS 1638) Contamination class (NAS 1638)	11 / 12

COME ORDINARE / HOW TO ORDER

PF3U 64 D

Rotazione / Rotation

D = destra/cw

S = sinistra/ccw

R = reversibile/bidirectional

Cilindrata / Capacity

Tipo pompa / pump type

POMPE AD INGRANAGGI

GEAR PUMPS

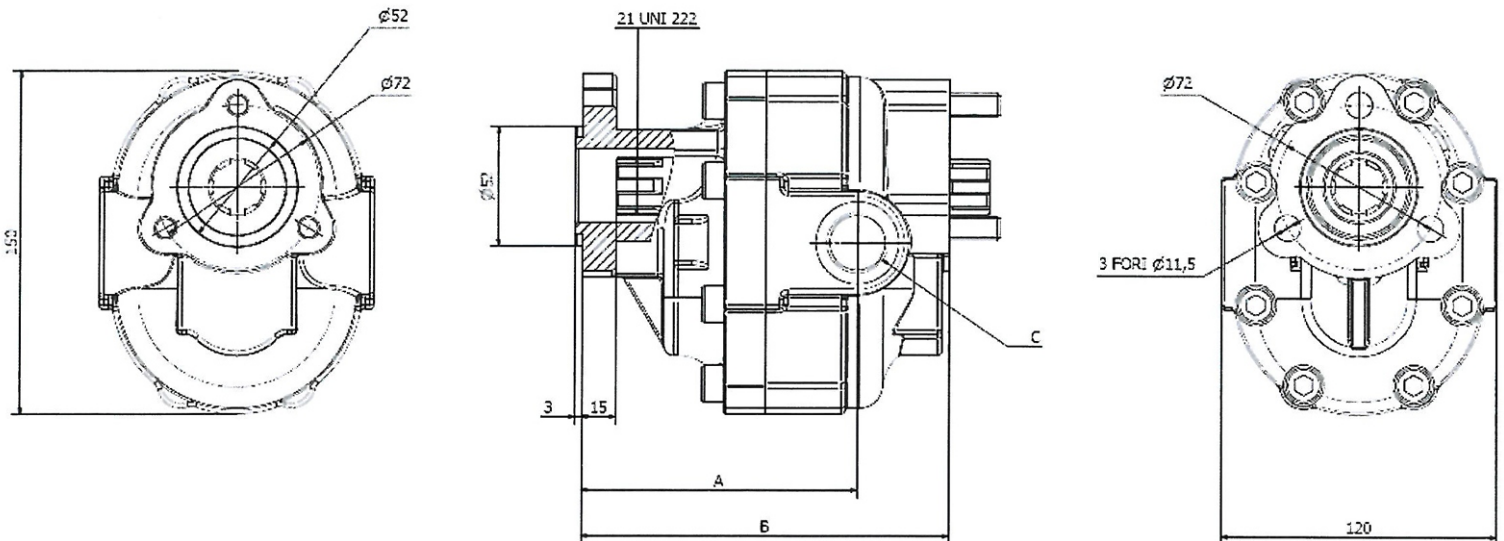
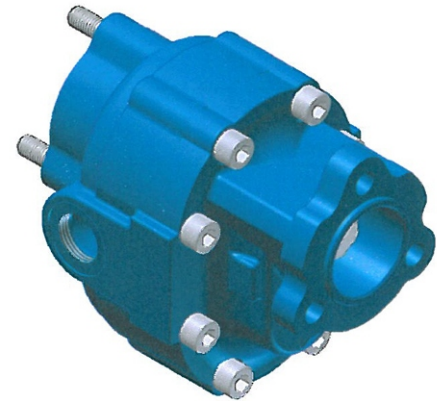

TIPO Type	Cilind. Cm^3/giro Capacity $\text{Cm}^3/\text{rev.}$	A	B	C		Peso Kg. Weight Kg.
				Aspirazione Inlet	Mandata Outlet	
PF3 - 25	24.9	135	175	3/4"	1/2"	11.6
PF3 - 35	34.3	141	187	3/4"	1/2"	12.6
PF3 - 45	45.2	131	194	1"	3/4"	13.1
PF3 - 55	54.5	137	200	1"	3/4"	13.7
PF3 - 64	63.9	143	206	1"	3/4"	14.5
PF3 - 80	78.7	143	216	1"-1/4"	1"	14.8

CARATTERISTICHE PRINCIPALI / MAIN FEATURES

Tipo - Type		25	35	45	55	64	80
Cilindrata Capacity	Cm ³ / giro Cm ³ / rev	24.9	34.3	45.2	54.5	63.9	78.7
P1 Pressione max continua Max working pressure	Bar	300	300	260	240	220	200
P3 Pressione max di picco Max peak pressure	Bar	450	450	400	380	330	300
Velocità max per pressione P1 Max speed for P1 pressure	Giri / min Rpm	2200	2200	2200	2000	1800	1500
Velocità max a vuoto Max speed without load	Giri / min Rpm	2800	2800	2800	2500	2500	2200

Per pompe reversibili ridurre la pressione del 15%
For bi-directional pump pressure is reduced by 15%

DIAGRAMMI / DIAGRAMS

CILINDRATA / CAPACITY

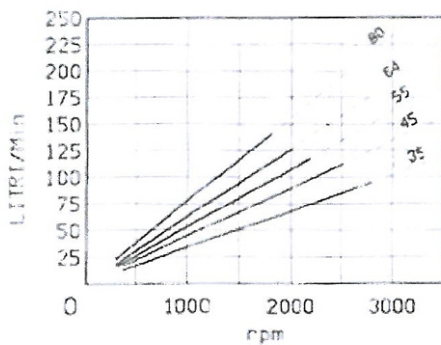

POT. ASSORBITA / INPUT POWER

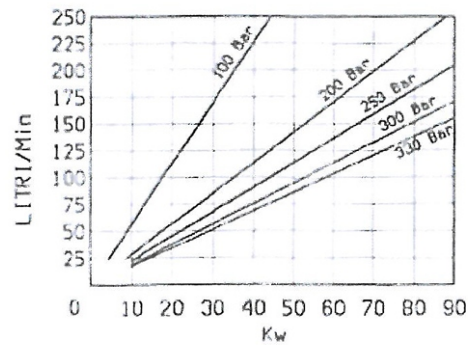

COPPIA. ASSORBITA / INPUT TORQUE

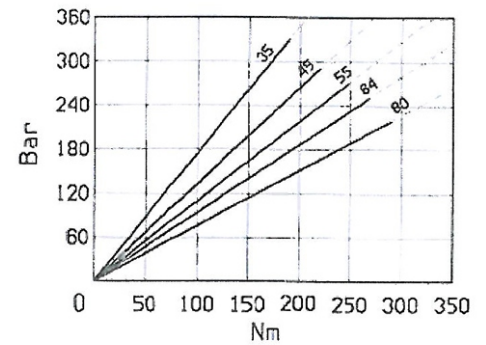

CONDIZIONI DI LAVORO / WORKING CONDITIONS

Temperatura d'esercizio Working temperature	-10° +80°C
Campo di viscosità Operating viscosity	12 / 110 cSt
Contaminazione (NAS 1638) Contamination class (NAS 1638)	11 / 12

COME ORDINARE / HOW TO ORDER

POMPE AD INGRANAGGI

PF3IT 64 D

Rotazione / Rotation

D = destra/cw

S = sinistra/ccw

R = reversibile/bidirectional

Cilindrata / Capacity

Tipo pompa / pump type

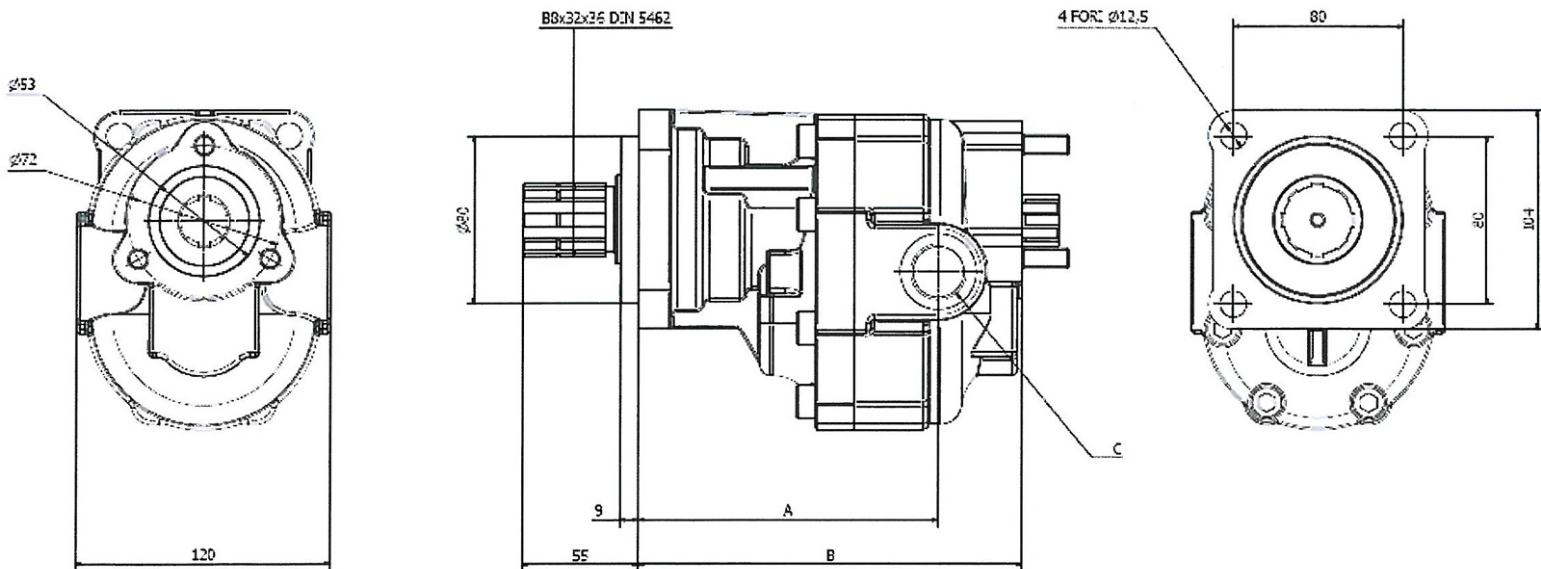
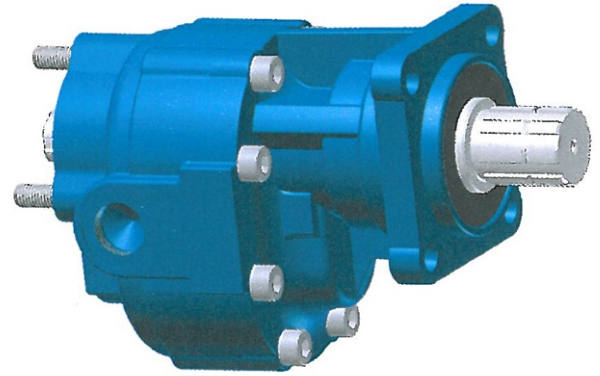

TIPO Type	Cilind. Cm ³ /giro Capacity Cm ³ /rev.	A	B	C		Peso Kg. Weight Kg.
				Aspirazione Inlet	Mandata Outlet	
PF3 - 25	24.9	135	175	3/4"	1/2"	11.6
PF3 - 35	34.3	141	187	3/4"	1/2"	12.6
PF3 - 45	45.2	131	194	1"	3/4"	13.1
PF3 - 55	54.5	137	200	1"	3/4"	13.7
PF3 - 64	63.9	143	206	1"	3/4"	14.5
PF3 - 80	78.7	143	216	1"-1/4"	1"	14.8

CARATTERISTICHE PRINCIPALI / MAIN FEATURES

Tipo - Type		25	35	45	55	64	80
Cilindrata Capacity	Cm ³ / giro Cm ³ / rev	24.9	34.3	45.2	54.5	63.9	78.7
P1 Pressione max continua Max working pressure	Bar	300	300	260	240	220	200
P3 Pressione max di picco Max peak pressure	Bar	450	450	400	380	330	300
Velocità max per pressione P1 Max speed for P1 pressure	Giri / min Rpm	2200	2200	2200	2000	1800	1500
Velocità max a vuoto Max speed without load	Giri / min Rpm	2800	2800	2800	2500	2500	2200

Per pompe reversibili ridurre la pressione del 15%
For bi-directional pump pressure is reduced by 15%

DIAGRAMMI / DIAGRAMS

CILINDRATA / CAPACITY

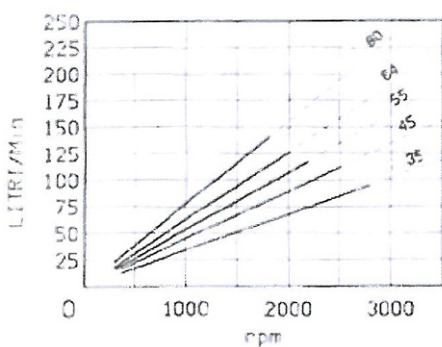

POT. ASSORBITA / INPUT POWER

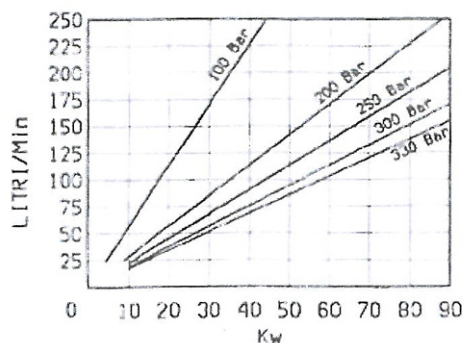

COPPIA. ASSORBITA / INPUT TORQUE

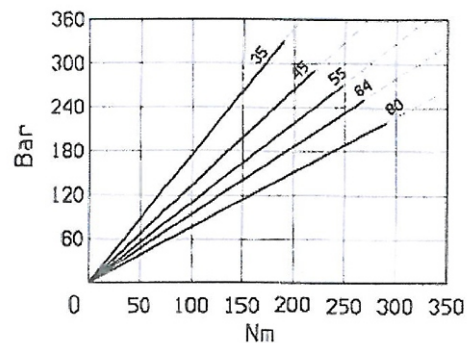

CONDIZIONI DI LAVORO / WORKING CONDITIONS

Temperatura d'esercizio Working temperature	-10° +80°C
Campo di viscosità Operating viscosity	12 / 110 cSt
Contaminazione (NAS 1638) Contamination class (NAS 1638)	11 / 12

COME ORDINARE / HOW TO ORDER

PF3I 64 D

Rotazione / Rotation

D = destra/cw

S = sinistra/ccw

R = reversibile/bidirectional

Cilindrata / Capacity

Tipo pompa / pump type

POMPE AD INGRANAGGI

GEAR PUMPS

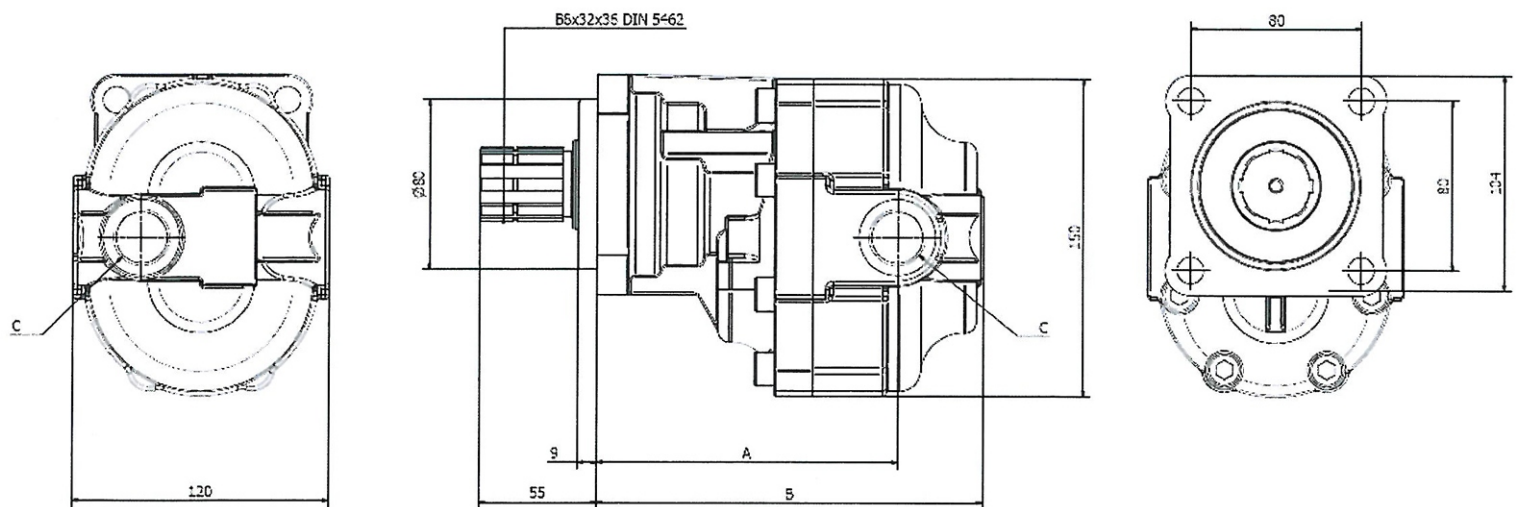
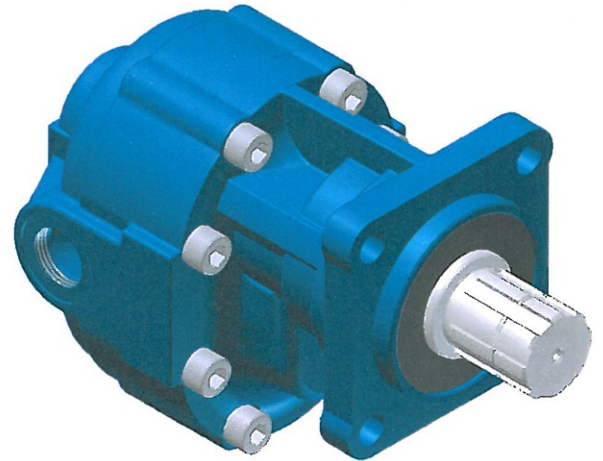

TIPO Type	Cilind. Cm ³ /giro Capacity Cm ³ /rev.	A	B	C		Peso Kg. Weight Kg.
				Aspirazione Inlet	Mandata Outlet	
PF3 - 25	24.9	135	175	3/4"	1/2"	11.6
PF3 - 35	34.3	141	187	3/4"	1/2"	12.6
PF3 - 45	45.2	131	194	1"	3/4"	13.1
PF3 - 55	54.5	137	200	1"	3/4"	13.7
PF3 - 64	63.9	143	206	1"	3/4"	14.5
PF3 - 80	78.7	143	216	1"-1/4	1"	14.8

CARATTERISTICHE PRINCIPALI / MAIN FEATURES

Tipo - Type		25	35	45	55	64	80
Cilindrata Capacity	Cm ³ / giro Cm ³ / rev	24.9	34.3	45.2	54.5	63.9	78.7
P1 Pressione max continua Max working pressure	Bar	300	300	260	240	220	200
P3 Pressione max di picco Max peak pressure	Bar	450	450	400	380	330	300
Velocità max per pressione P1 Max speed for P1 pressure	Giri / min Rpm	2200	2200	2200	2000	1800	1500
Velocità max a vuoto Max speed without load	Giri / min Rpm	2800	2800	2800	2500	2500	2200

Per pompe reversibili ridurre la pressione del 15%
For bi-directional pump pressure is reduced by 15%

DIAGRAMMI / DIAGRAMS

CILINDRATA / CAPACITY

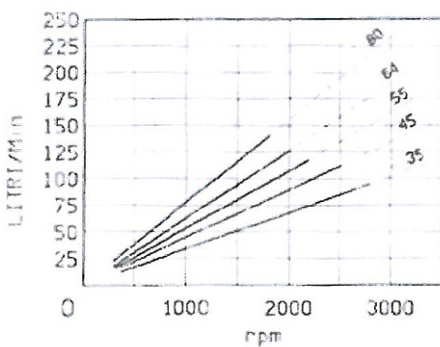

POT. ASSORBITA / INPUT POWER

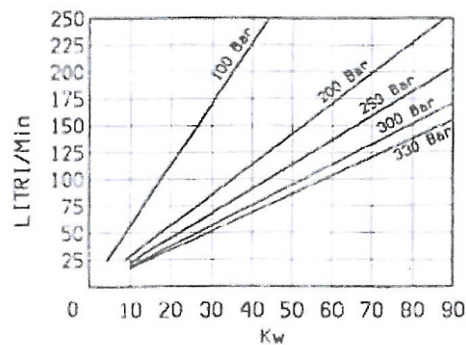

COPPIA. ASSORBITA / INPUT TORQUE

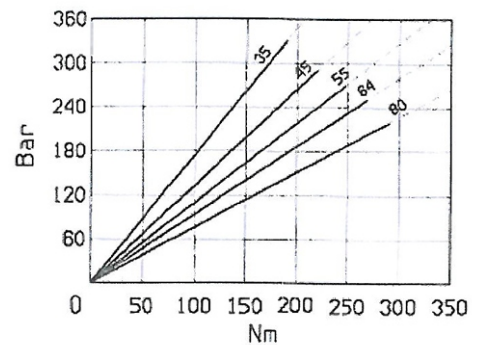

CONDIZIONI DI LAVORO / WORKING CONDITIONS

Temperatura d'esercizio Working temperature	-10° +80°C
Campo di viscosità Operating viscosity	12 / 110 cSt
Contaminazione (NAS 1638) Contamination class (NAS 1638)	11 / 12

COME ORDINARE / HOW TO ORDER

PF3U 64 D

Rotazione / Rotation

D = destra/cw

S = sinistra/ccw

R = reversibile/bidirectional

Cilindrata / Capacity

Tipo pompa / pump type

POMPE AD INGRANAGGI

GEAR PUMPS

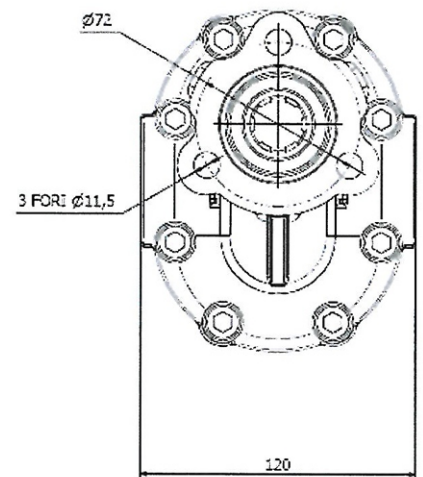
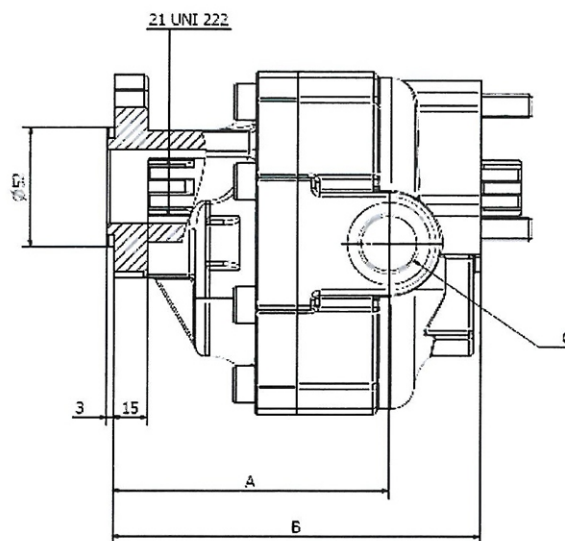
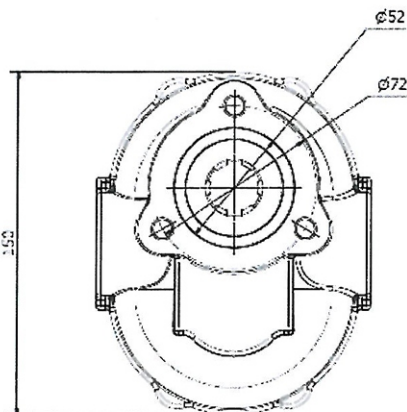
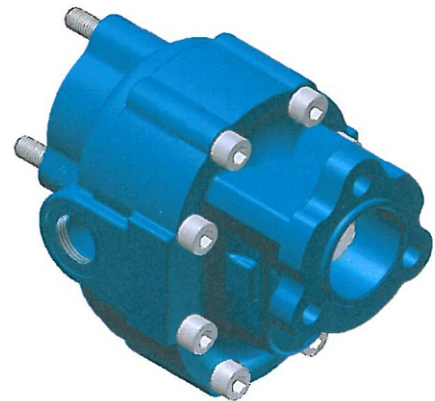

TIPO Type	Cilind. Cm ³ /giro Capacity Cm ³ /rev.	A	B	C		Peso Kg. Weight Kg.
				Aspirazione Inlet	Mandata Outlet	
PF3 - 25	24.9	135	175	3/4"	1/2"	11.6
PF3 - 35	34.3	141	187	3/4"	1/2"	12.6
PF3 - 45	45.2	131	194	1"	3/4"	13.1
PF3 - 55	54.5	137	200	1"	3/4"	13.7
PF3 - 64	63.9	143	206	1"	3/4"	14.5
PF3 - 80	78.7	143	216	1"-1/4	1"	14.8

CARATTERISTICHE PRINCIPALI / MAIN FEATURES

Tipo - Type		25	35	45	55	64	80
Cilindrata Capacity	Cm ³ / giro Cm ³ / rev	24.9	34.3	45.2	54.5	63.9	78.7
P1 Pressione max continua Max working pressure	Bar	300	300	260	240	220	200
P3 Pressione max di picco Max peak pressure	Bar	450	450	400	380	330	300
Velocità max per pressione P1 Max speed for P1 pressure	Giri / min Rpm	2200	2200	2200	2000	1800	1500
Velocità max a vuoto Max speed without load	Giri / min Rpm	2800	2800	2800	2500	2500	2200

Per pompe reversibili ridurre la pressione del 15%
For bi-directional pump pressure is reduced by 15%

DIAGRAMMI / DIAGRAMS

CILINDRATA / CAPACITY

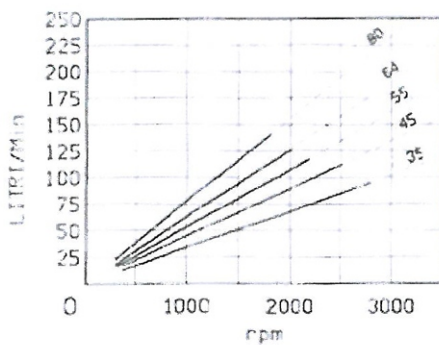

POT. ASSORBITA / INPUT POWER

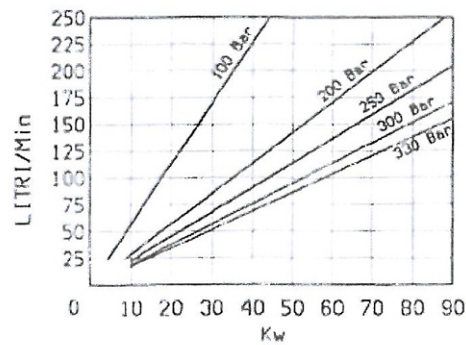

COPPIA. ASSORBITA / INPUT TORQUE

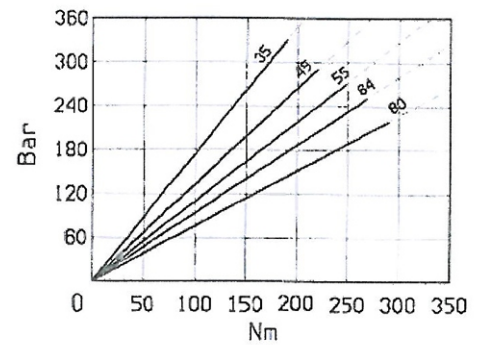

CONDIZIONI DI LAVORO / WORKING CONDITIONS

Temperatura d'esercizio Working temperature	-10° +80°C
Campo di viscosità Operating viscosity	12 / 110 cSt
Contaminazione (NAS 1638) Contamination class (NAS 1638)	11 / 12

COME ORDINARE / HOW TO ORDER

POMPE AD INGRANAGGI

PF3IT 64 D

Rotazione / Rotation

D = destra/cw

S = sinistra/ccw

R = reversibile/bidirectional

Cilindrata / Capacity

Tipo pompa / pump type

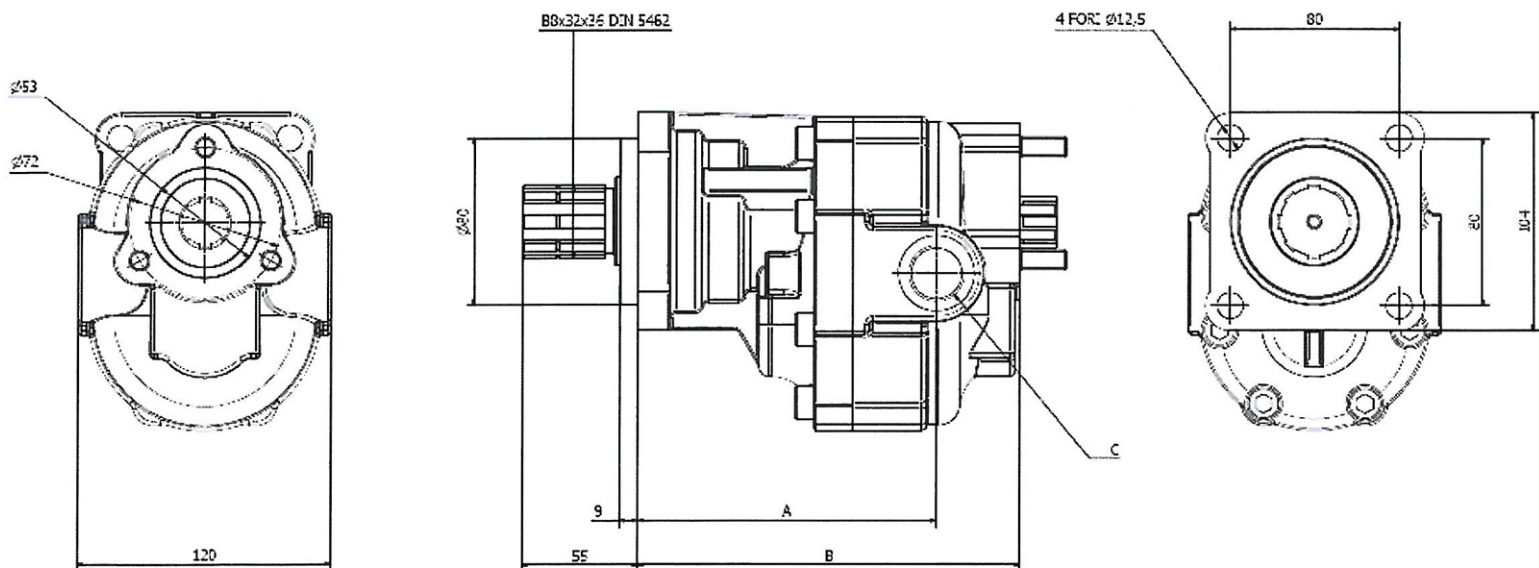
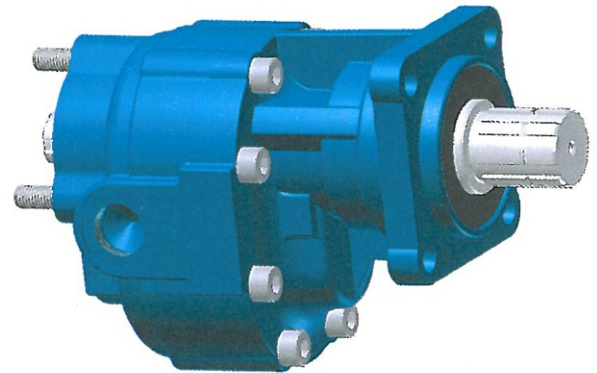

TIPO Type	Cilind. Cm ³ /giro Capacity Cm ³ /rev.	A	B	C		Peso Kg. Weight Kg.
				Aspirazione Inlet	Mandata Outlet	
PF3 - 25	24.9	135	175	3/4"	1/2"	11.6
PF3 - 35	34.3	141	187	3/4"	1/2"	12.6
PF3 - 45	45.2	131	194	1"	3/4"	13.1
PF3 - 55	54.5	137	200	1"	3/4"	13.7
PF3 - 64	63.9	143	206	1"	3/4"	14.5
PF3 - 80	78.7	143	216	1"-1/4	1"	14.8

CARATTERISTICHE PRINCIPALI / MAIN FEATURES

Tipo - Type		25	35	45	55	64	80
Cilindrata Capacity	Cm ³ / giro Cm ³ / rev	24.9	34.3	45.2	54.5	63.9	78.7
P1 Pressione max continua Max working pressure	Bar	300	300	260	240	220	200
P3 Pressione max di picco Max peak pressure	Bar	450	450	400	380	330	300
Velocità max per pressione P1 Max speed for P1 pressure	Giri / min Rpm	2200	2200	2200	2000	1800	1500
Velocità max a vuoto Max speed without load	Giri / min Rpm	2800	2800	2800	2500	2500	2200

Per pompe reversibili ridurre la pressione del 15%
For bi-directional pump pressure is reduced by 15%

DIAGRAMMI / DIAGRAMS

CILINDRATA / CAPACITY

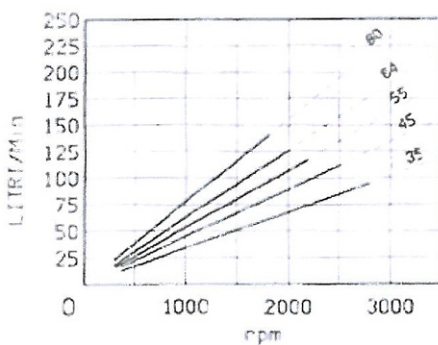

POT. ASSORBITA / INPUT POWER

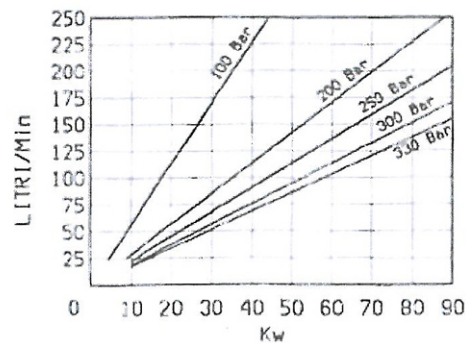

COPPIA. ASSORBITA / INPUT TORQUE

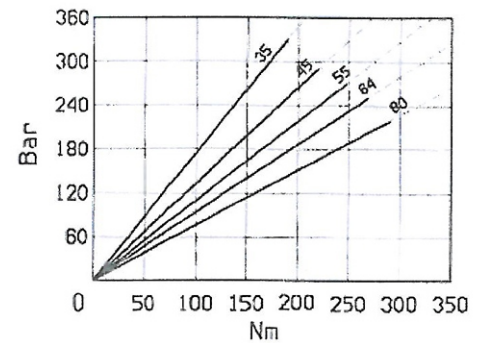

CONDIZIONI DI LAVORO / WORKING CONDITIONS

Temperatura d'esercizio Working temperature	-10° +80°C
Campo di viscosità Operating viscosity	12 / 110 cSt
Contaminazione (NAS 1638) Contamination class (NAS 1638)	11 / 12

COME ORDINARE / HOW TO ORDER

PF3I 64 D

Rotazione / Rotation

D = destra/cw

S = sinistra/ccw

R = reversibile/bidirectional

Cilindrata / Capacity

Tipo pompa / pump type

POMPE AD INGRANAGGI

GEAR PUMPS

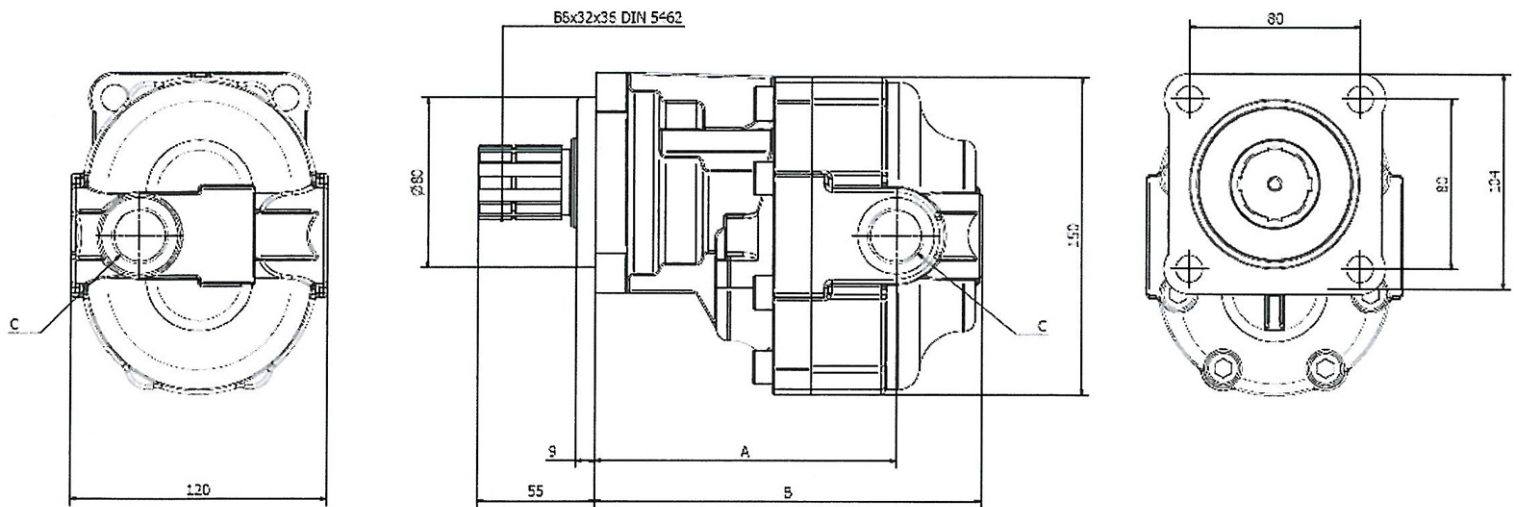
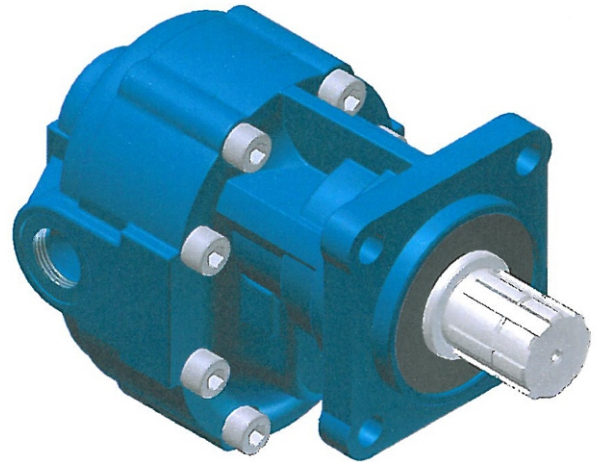

TIPO Type	Cilind. Cm ³ /giro Capacity Cm ³ /rev.	A	B	C		Peso Kg. Weight Kg.
				Aspirazione Inlet	Mandata Outlet	
PF3 - 25	24.9	135	175	3/4"	1/2"	11.6
PF3 - 35	34.3	141	187	3/4"	1/2"	12.6
PF3 - 45	45.2	131	194	1"	3/4"	13.1
PF3 - 55	54.5	137	200	1"	3/4"	13.7
PF3 - 64	63.9	143	206	1"	3/4"	14.5
PF3 - 80	78.7	143	216	1"-1/4	1"	14.8

CARATTERISTICHE PRINCIPALI / MAIN FEATURES

Tipo - Type		25	35	45	55	64	80
Cilindrata Capacity	Cm ³ / giro Cm ³ / rev	24.9	34.3	45.2	54.5	63.9	78.7
P1 Pressione max continua Max working pressure	Bar	300	300	260	240	220	200
P3 Pressione max di picco Max peak pressure	Bar	450	450	400	380	330	300
Velocità max per pressione P1 Max speed for P1 pressure	Giri / min Rpm	2200	2200	2200	2000	1800	1500
Velocità max a vuoto Max speed without load	Giri / min Rpm	2800	2800	2800	2500	2500	2200

Per pompe reversibili ridurre la pressione del 15%
For bi-directional pump pressure is reduced by 15%

DIAGRAMMI / DIAGRAMS

CILINDRATA / CAPACITY

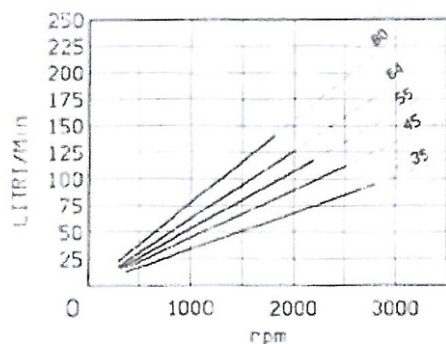

POT. ASSORBITA / INPUT POWER

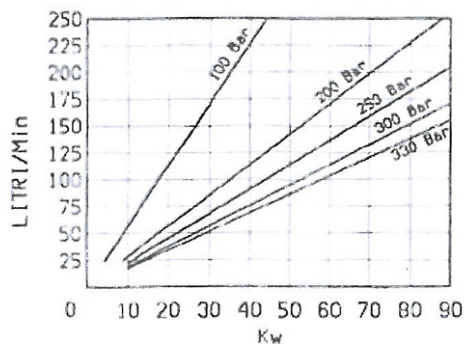

COPPIA. ASSORBITA / INPUT TORQUE

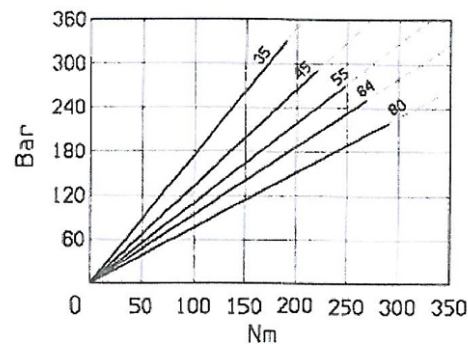

CONDIZIONI DI LAVORO / WORKING CONDITIONS

Temperatura d'esercizio Working temperature	-10° +80°C
Campo di viscosità Operating viscosity	12 / 110 cSt
Contaminazione (NAS 1638) Contamination class (NAS 1638)	11 / 12

COME ORDINARE / HOW TO ORDER

PF4I 110 D

Rotazione / Rotation

D = destra/cw

S = sinistra/ccw

Cilindrata / Capacity

Tipo pompa / pump type

POMPE AD INGRANAGGI

GEAR PUMPS

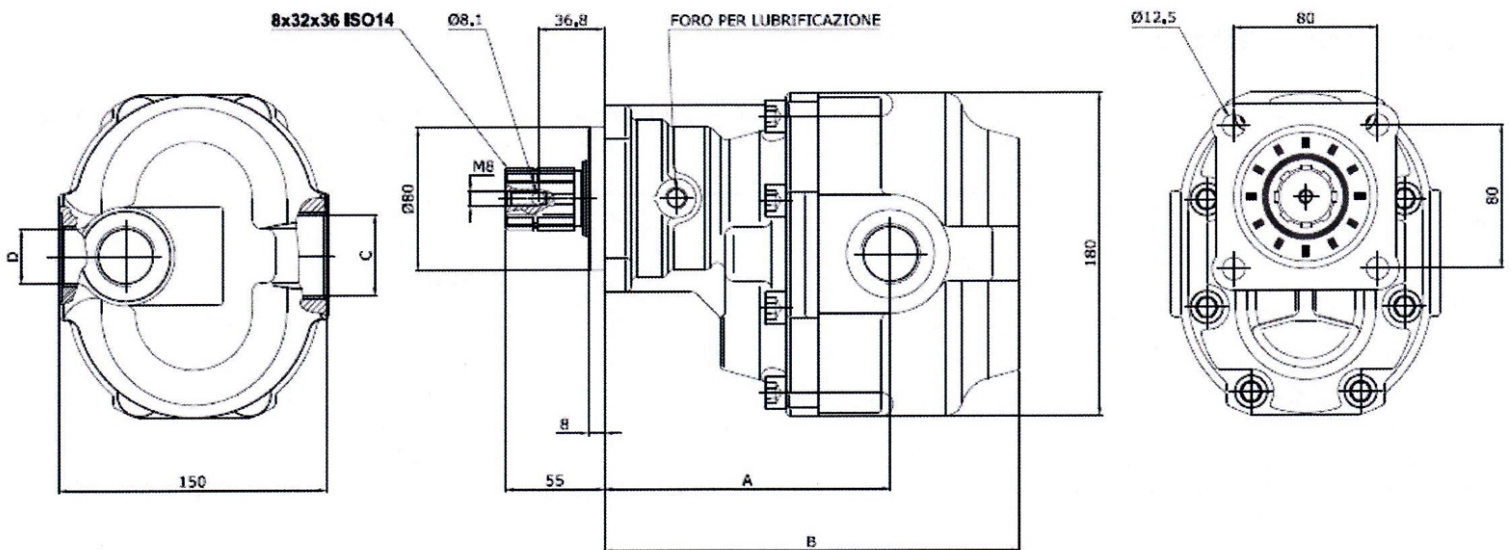
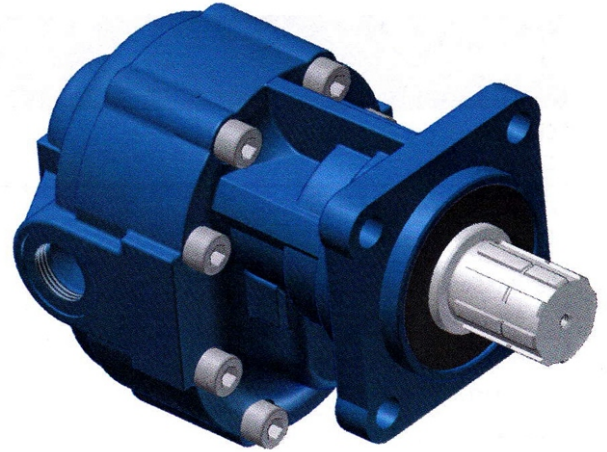

TIPO Type	Cilind. Cm ³ /giro Capacity Cm ³ /rev.	A	B	C	D	Peso Kg. Weight Kg.
				Aspirazione Inlet	Mandata Outlet	
PF4 - 75	72.1	152	216	1"-1/4 G	1"G	19.5
PF4 - 90	88.7	158	222	1"-1/4 G	1"G	20.3
PF4 - 110	105.4	164	228	1"-1/4 G	1"G	21.5
PF4 - 130	127.5	160	236	1"-1/4 G	1"G	22.6
PF4 - 150	149.7	168	244	1"-1/4 G	1"G	23.1

CARATTERISTICHE PRINCIPALI / MAIN FEATURES

Tipo - Type		75	90	110	130	150
Cilindrata Capacity	Cm^3/giro Cm^3/rev	72.1	88.7	105.4	127.5	149.7
P1 Pressione max continua Max working pressure	Bar	300	250	250	210	180
P3 Pressione max di picco Max peak pressure	Bar	450	375	375	315	270
Velocità max per pressione P1 Max speed for P1 pressure	Giri / min Rpm	1800	1800	1500	1500	1500
Velocità minima intermittente Min intermittent speed (30sec.)	Giri / min Rpm	300	300	250	250	250

DIAGRAMMI / DIAGRAMS

CILINDRATA / CAPACITY

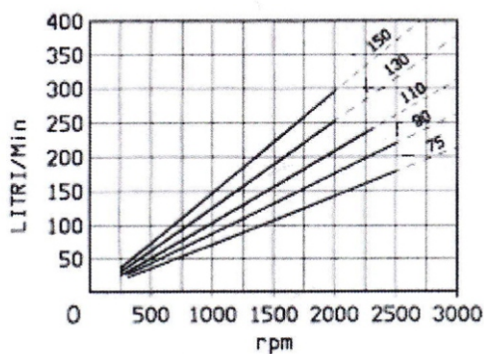

POT. ASSORBITA / INPUT POWER

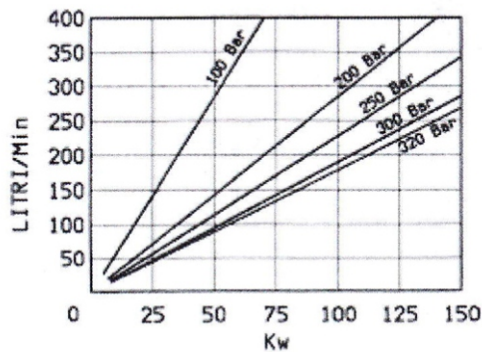

COPPIA. ASSORBITA / INPUT TORQUE

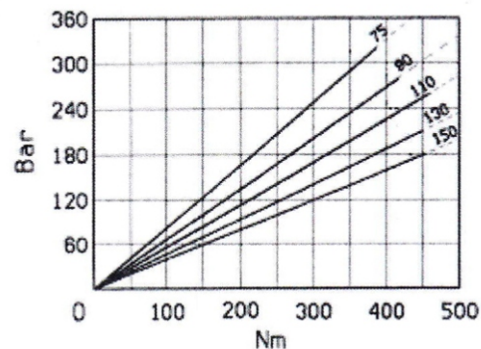

CONDIZIONI DI LAVORO / WORKING CONDITIONS

Temperatura d'esercizio Working temperature	-10° +80°C
Campo di viscosità Operating viscosity	12 / 110 cSt
Contaminazione (NAS 1638) Contamination class (NAS 1638)	11 / 12

COME ORDINARE / HOW TO ORDER

PF4IT 110 D

Rotazione / Rotation

D = destra/cw

S = sinistra/ccw

Cilindrata / Capacity

Tipo pompa / pump type

POMPE AD INGRANAGGI

GEAR PUMPS

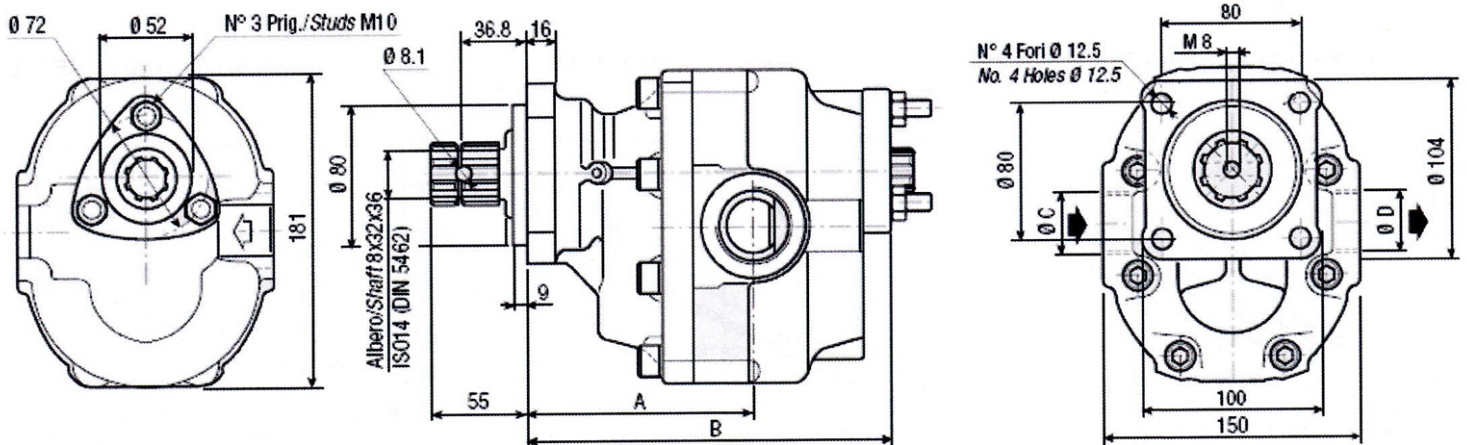
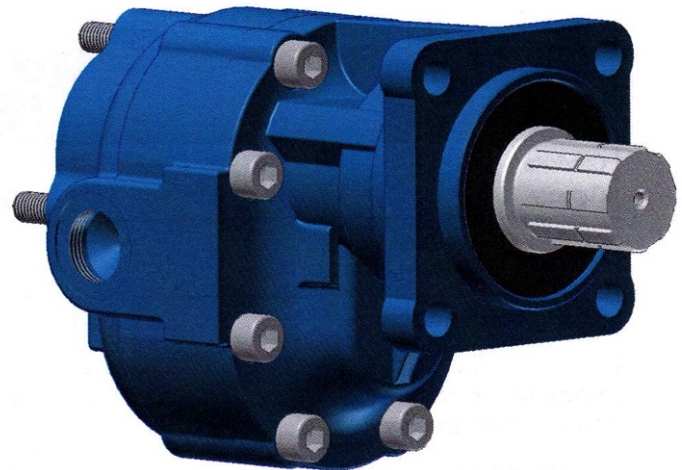

TIPO Type	Cilind. Cm ³ /giro Capacity Cm ³ /rev.	A	B	C	D	Peso Kg. Weight Kg.
				Aspirazione Inlet	Mandata Outlet	
PF4 - 75	72.1	152	216	1"-1/4 G	1"G	19.5
PF4 - 90	88.7	158	222	1"-1/4 G	1"G	20.3
PF4 - 110	105.4	164	228	1"-1/4 G	1"G	21.5
PF4 - 130	127.5	160	236	1"-1/4 G	1"G	22.6
PF4 - 150	149.7	168	244	1"-1/4 G	1"G	23.1

CARATTERISTICHE PRINCIPALI / MAIN FEATURES

Tipo - Type		75	90	110	130	150
Cilindrata Capacity	Cm^3/giro Cm^3/rev	72.1	88.7	105.4	127.5	149.7
P1 Pressione max continua Max working pressure	Bar	300	250	250	210	180
P3 Pressione max di picco Max peak pressure	Bar	450	375	375	315	270
Velocità max per pressione P1 Max speed for P1 pressure	Giri / min Rpm	1800	1800	1500	1500	1500
Velocità minima intermittente Min intermittent speed (30sec.)	Giri / min Rpm	300	300	250	250	250

DIAGRAMMI / DIAGRAMS

CILINDRATA / CAPACITY

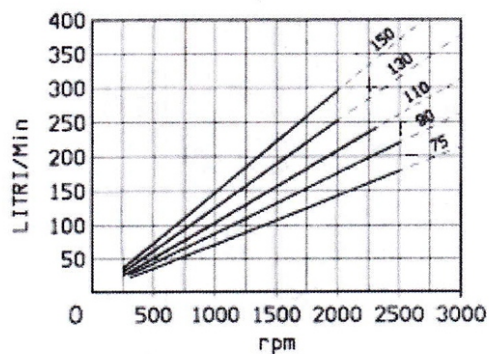

POT. ASSORBITA / INPUT POWER

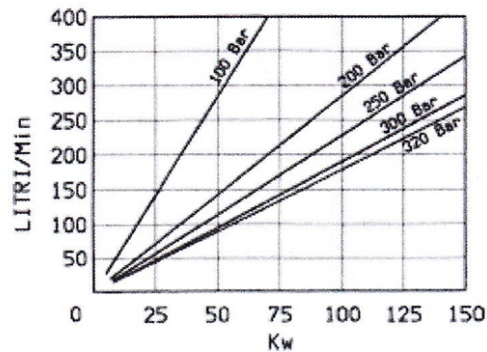

COPPIA. ASSORBITA / INPUT TORQUE

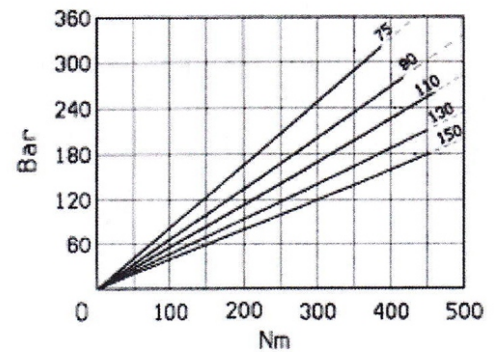

CONDIZIONI DI LAVORO / WORKING CONDITIONS

Temperatura d'esercizio Working temperature	-10° +80°C
Campo di viscosità Operating viscosity	12 / 110 cSt
Contaminazione (NAS 1638) Contamination class (NAS 1638)	11 / 12

COME ORDINARE / HOW TO ORDER

PF4U 110 D

Rotazione / Rotation

D = destra/cw

S = sinistra/ccw

Cilindrata / Capacity

Tipo pompa / pump type

POMPE AD INGRANAGGI

GEAR PUMPS

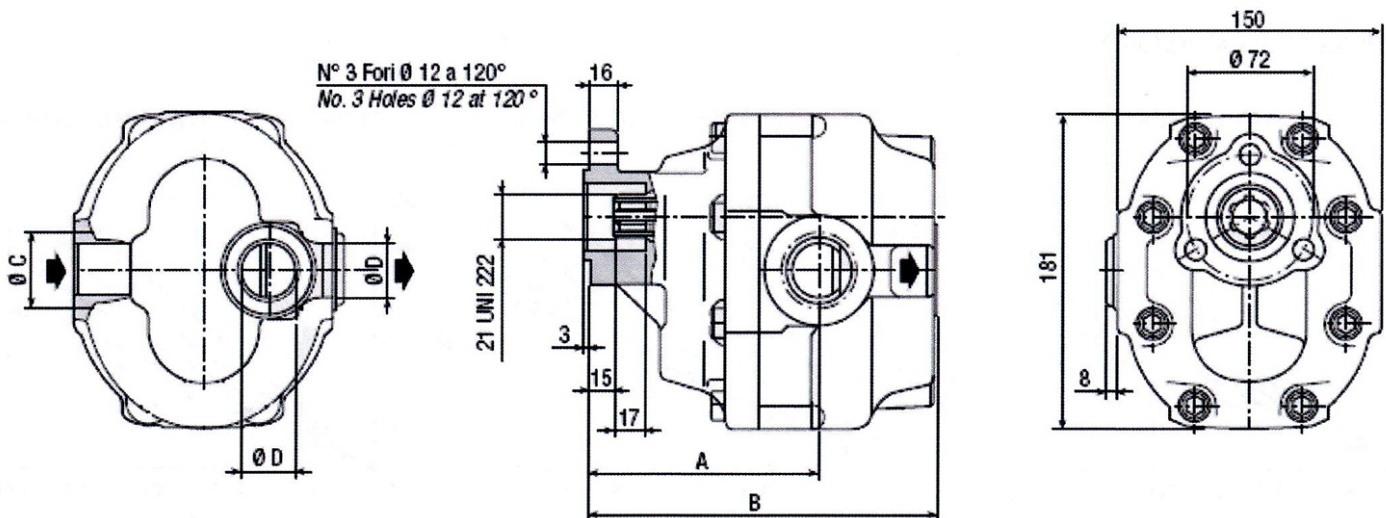
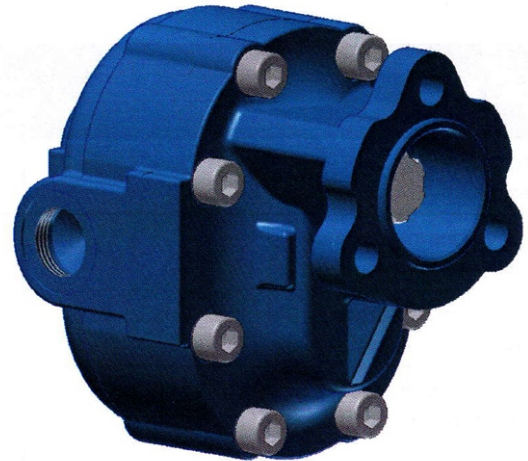

TIPO Type	Cilind. Cm ³ /giro Capacity Cm ³ /rev.	A	B	C	D	Peso Kg. Weight Kg.
				Aspirazione Inlet	Mandata Outlet	
PF4 - 75	72.1	152	216	1"-1/4 G	1"G	19.5
PF4 - 90	88.7	158	222	1"-1/4 G	1"G	20.3
PF4 - 110	105.4	164	228	1"-1/4 G	1"G	21.5
PF4 - 130	127.5	160	236	1"-1/4 G	1"G	22.6
PF4 - 150	149.7	168	244	1"-1/4 G	1"G	23.1

CARATTERISTICHE PRINCIPALI / MAIN FEATURES

Tipo - Type		75	90	110	130	150
Cilindrata Capacity	Cm^3/giro Cm^3/rev	72.1	88.7	105.4	127.5	149.7
P1 Pressione max continua Max working pressure	Bar	300	250	250	210	180
P3 Pressione max di picco Max peak pressure	Bar	450	375	375	315	270
Velocità max per pressione P1 Max speed for P1 pressure	Giri / min Rpm	1800	1800	1500	1500	1500
Velocità minima intermittente Min intermittent speed (30sec.)	Giri / min Rpm	300	300	250	250	250

DIAGRAMMI / DIAGRAMS

CILINDRATA / CAPACITY

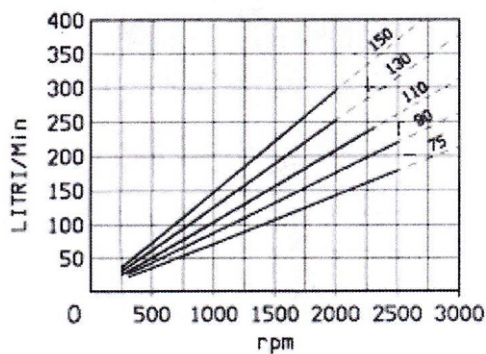

POT. ASSORBITA / INPUT POWER

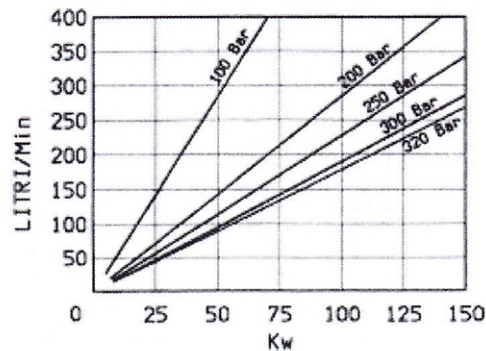

COPPIA. ASSORBITA / INPUT TORQUE

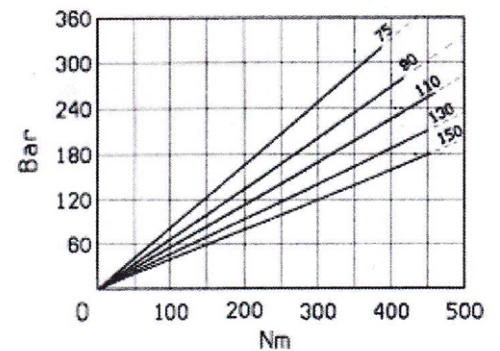

CONDIZIONI DI LAVORO / WORKING CONDITIONS

Temperatura d'esercizio Working temperature	-10° +80°C
Campo di viscosità Operating viscosity	12 / 110 cSt
Contaminazione (NAS 1638) Contamination class (NAS 1638)	11 / 12

COME ORDINARE / HOW TO ORDER

PF4UT 110 D

Rotazione / Rotation

D = destra/cw

S = sinistra/ccw

Cilindrata / Capacity

Tipo pompa / pump type

POMPE AD INGRANAGGI

GEAR PUMPS

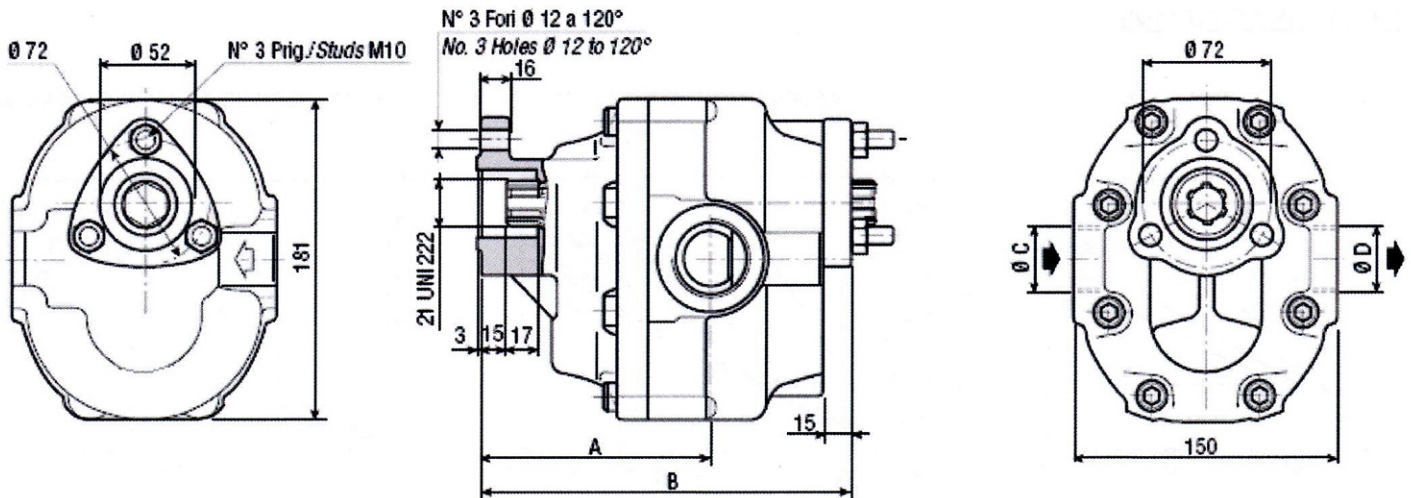
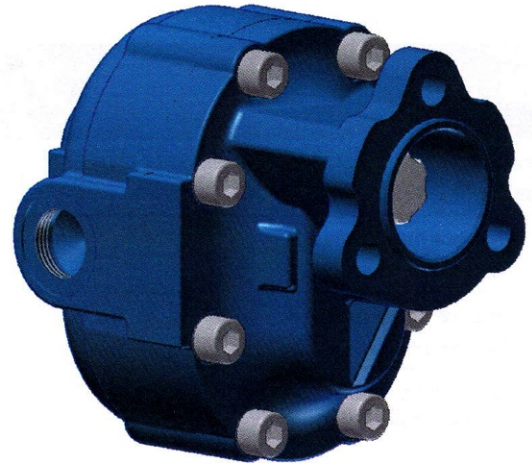

TIPO Type	Cilind. Cm ³ /giro Capacity Cm ³ /rev.	A	B	C	D	Peso Kg. Weight Kg.
				Aspirazione Inlet	Mandata Outlet	
PF4 - 75	72.1	152	216	1"-1/4 G	1"G	19.5
PF4 - 90	88.7	158	222	1"-1/4 G	1"G	20.3
PF4 - 110	105.4	164	228	1"-1/4 G	1"G	21.5
PF4 - 130	127.5	160	236	1"-1/4 G	1"G	22.6
PF4 - 150	149.7	168	244	1"-1/4 G	1"G	23.1

CARATTERISTICHE PRINCIPALI / MAIN FEATURES

Tipo - Type		75	90	110	130	150
Cilindrata Capacity	Cm^3/giro Cm^3/rev	72.1	88.7	105.4	127.5	149.7
P1 Pressione max continua Max working pressure	Bar	300	250	250	210	180
P3 Pressione max di picco Max peak pressure	Bar	450	375	375	315	270
Velocità max per pressione P1 Max speed for P1 pressure	Giri / min Rpm	1800	1800	1500	1500	1500
Velocità minima intermittente Min intermittent speed (30sec.)	Giri / min Rpm	300	300	250	250	250

DIAGRAMMI / DIAGRAMS

CILINDRATA / CAPACITY

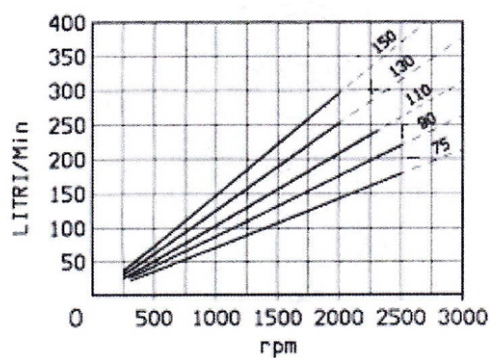

POT. ASSORBITA / INPUT POWER

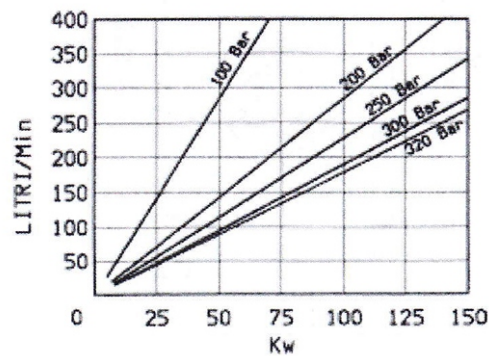

COPPIA. ASSORBITA / INPUT TORQUE

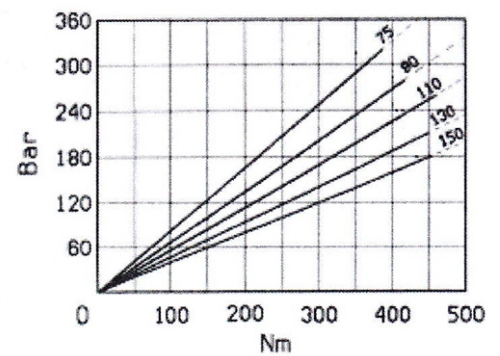

CONDIZIONI DI LAVORO / WORKING CONDITIONS

Temperatura d'esercizio Working temperature	-10° +80°C
Campo di viscosità Operating viscosity	12 / 110 cSt
Contaminazione (NAS 1638) Contamination class (NAS 1638)	11 / 12